

Fitting instructions

Make: Nissan

Pathfinder; 01/05->

Type: 4054

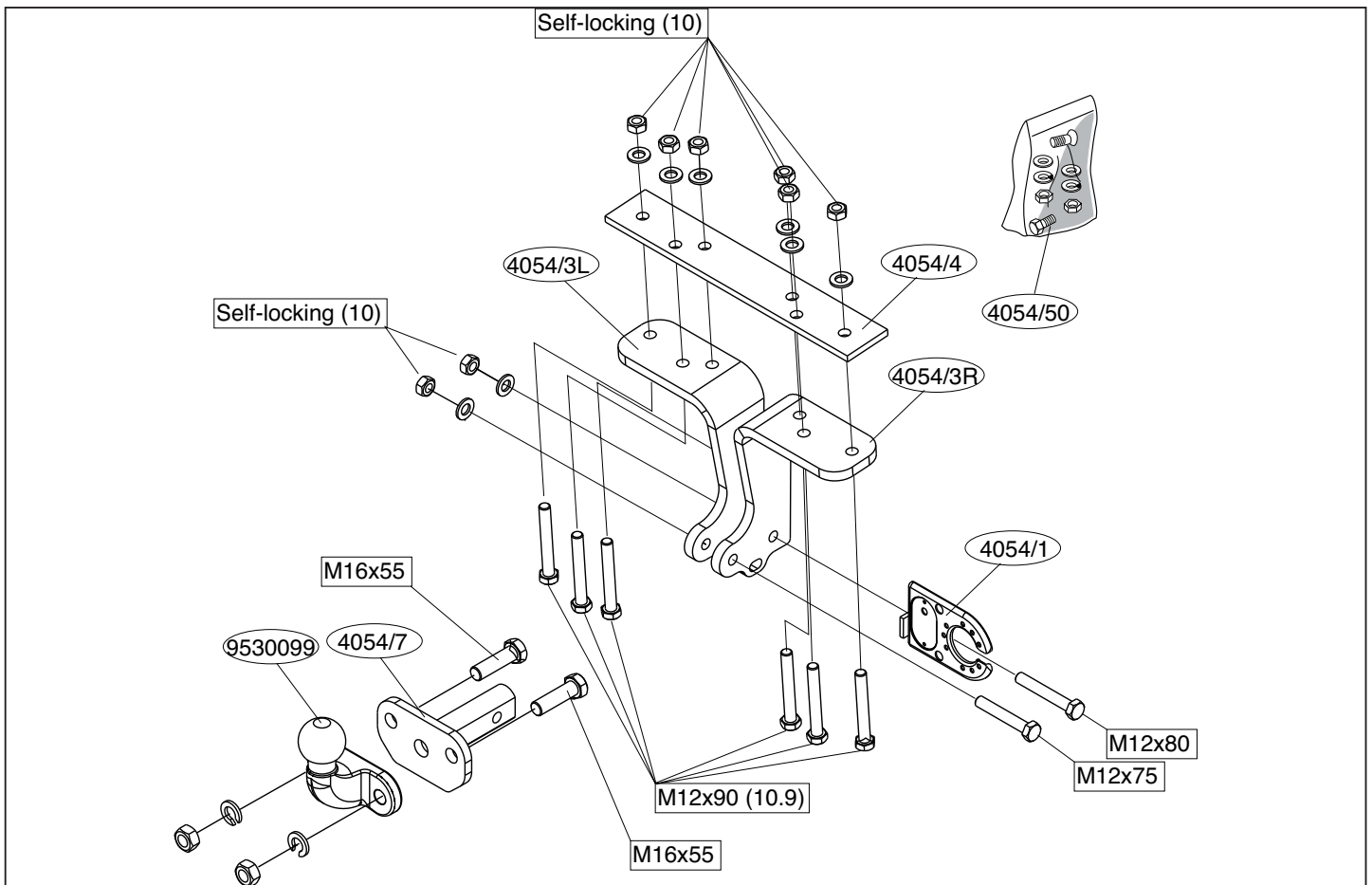

© 405470/05-09-08/1



Dispositivo di traino tipo: 4054
 Per autoveicoli: Nissan Pathfinder; 01/05->
 Tipo funzionale:

Classe e tipo di attacco: F
 Omologazione: e11 00-5426
 Valore D: 14,5 kN
 Carico Verticale max. S: 120 kg
 Larghezza rimorchiabile per Caravan e T.A.T.S.: 2,45m vedere CARTA di CIRCOLAZIONE VEICOLO (motrice) + 70 cm = ..arrotondare ai 5 cm superiore (vedi D.M.28/05/85)
 Massa rimorchiabile: vedi carta di circolazione dell' autoveicolo

Per verificare l' idoneità del dispositivo di traino omologato a norma CEE 94/20, all' installazione sulla vettura su cui si intende procedere al montaggio, compilare la seguente formula (se necessario declassare la massa rimorchiabile):

$$D = \frac{T \times C}{T + C} \times 0,00981 = \dots\dots\dots \text{kN}$$

dove: T= Massa Complessiva Max. della motrice (in kg)
 C= Massa Rimorchiabile Max. della motrice (in kg)

DA COMPILARE PER IL COLLAUDO

DICHIARAZIONE DI CORRETTO MONTAGGIO: la sottoscritta Ditta dichiara di aver montato in maniera corretta ed in conformi/ alle prescrizioni sia del costruttore del veicolo che del costruttore del dispositivo stesso il seguente dispositivo di attacco meccanico:

tipo:.....
 Il dispositivo di attacco sopra indicato è stato installato su autoveicolo
 modello:.....
 targa:.....
 Data:.....

TIMBRO e FIRMA

Si dichiara inoltre di aver informato l'utente del veicolo sull'USO e MANUTENZIONE del dispositivo stesso.

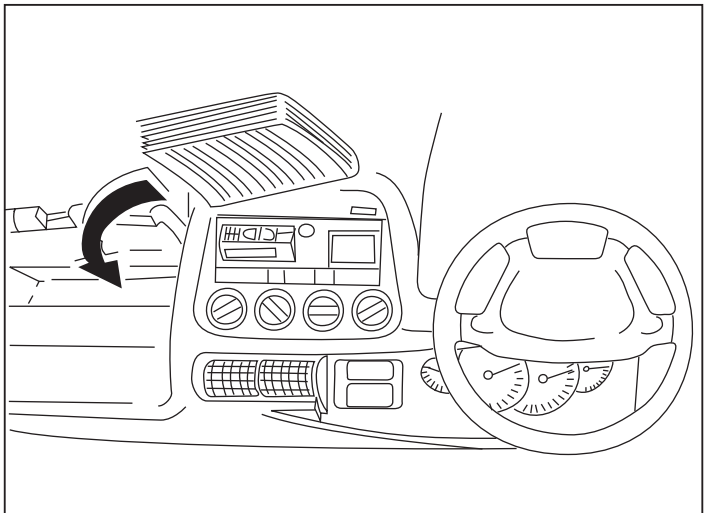
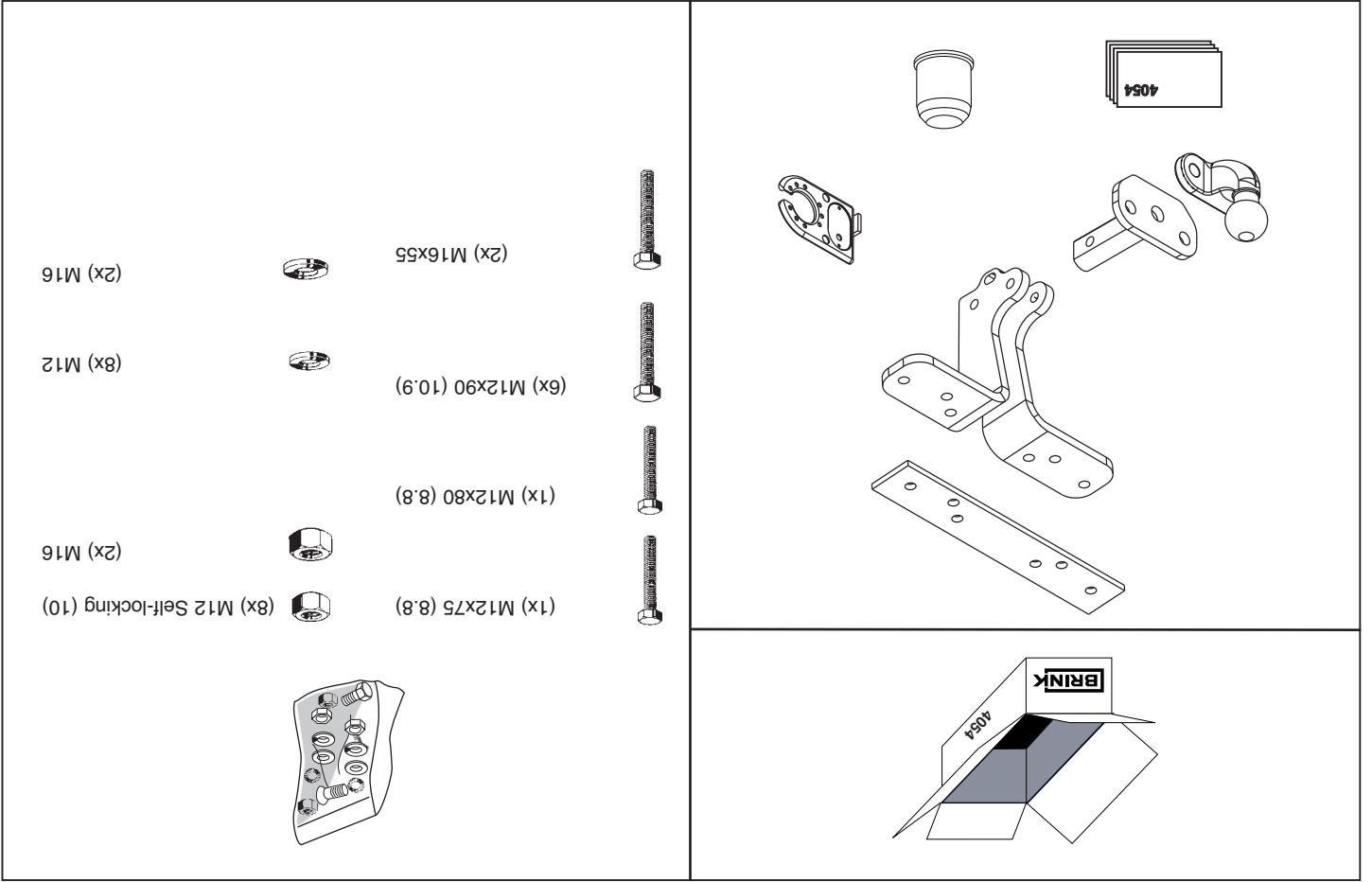

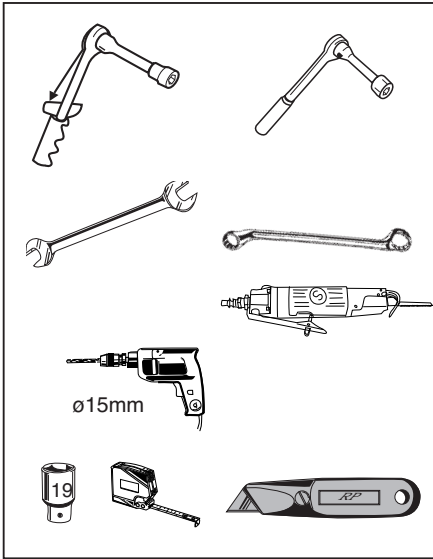

Couplingsclass: F

euro tested

94/20/EC

Approved
e11 00-5426

D-Value : 14,5 kN

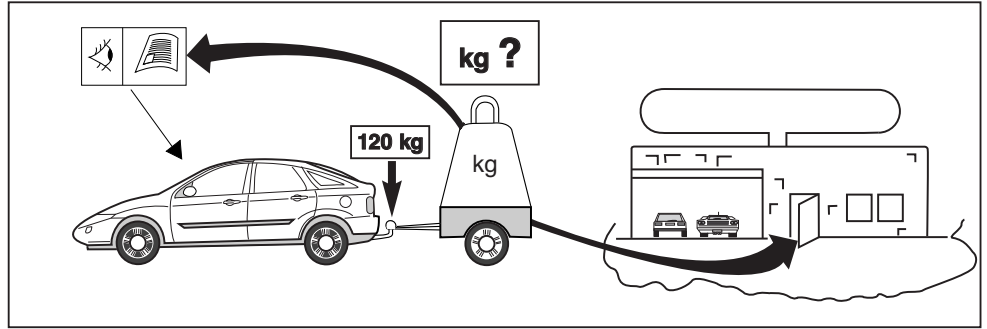

8.8

10.9



8

10

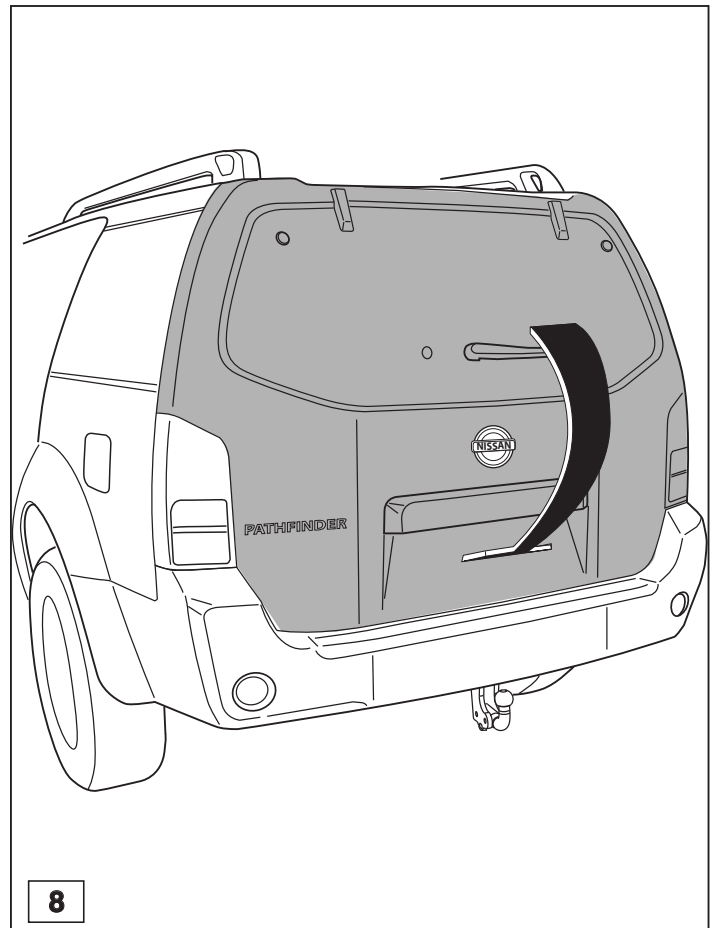
© 405470/05-09-08/3

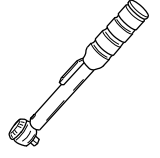
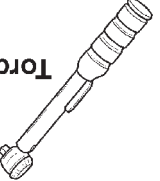
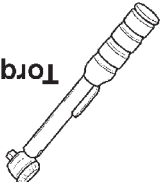

© 405470/05-09-08/8

 1000km	+	 0km	
M12 104 Nm (with self-locking nut)			
Torque settings for nuts and bolts (10.9)			
			
M16 195 Nm			
M12 79 Nm (with self-locking nut)			
Torque settings for nuts and bolts (8.8)			
			

HINWEISE:

- * Die für das Fahrzeug zugelassene Anhängelast ist den Fahrzeug Unterlagen zu entnehmen. Bei Änderungen des Fahrzeuggewichtes muß die höchstzulässige Anhängelast gegebenenfalls aus dem D-Wert nachgerechnet werden.
- * Auskunft hierüber kann ihr Fachhändler oder der TÜV geben.
- * Elektrische Anlage gemäß StVZO anbringen.

NOTE:

- * Should this installation process entail the cutting of the bumper – conformation **MUST** be obtained by the installation engineer or the customer's acceptance prior to completion. Brink International do not accept responsibility for any matters arising as a result of this miscommunication.



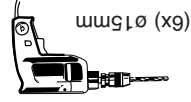

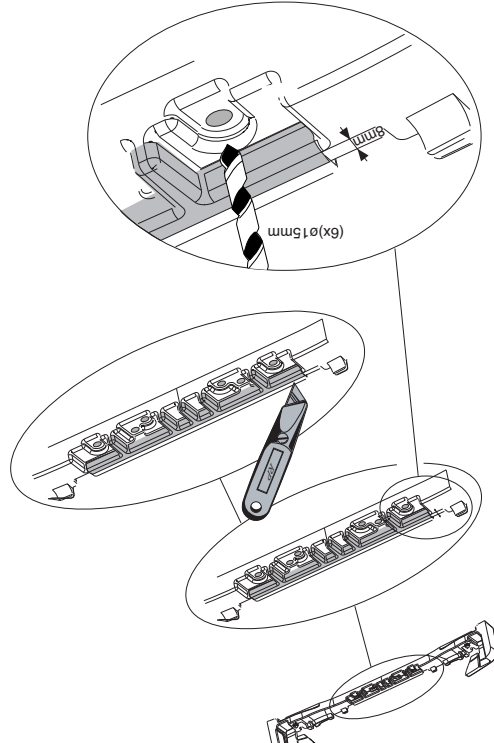

(6x) ø15mm

6







5

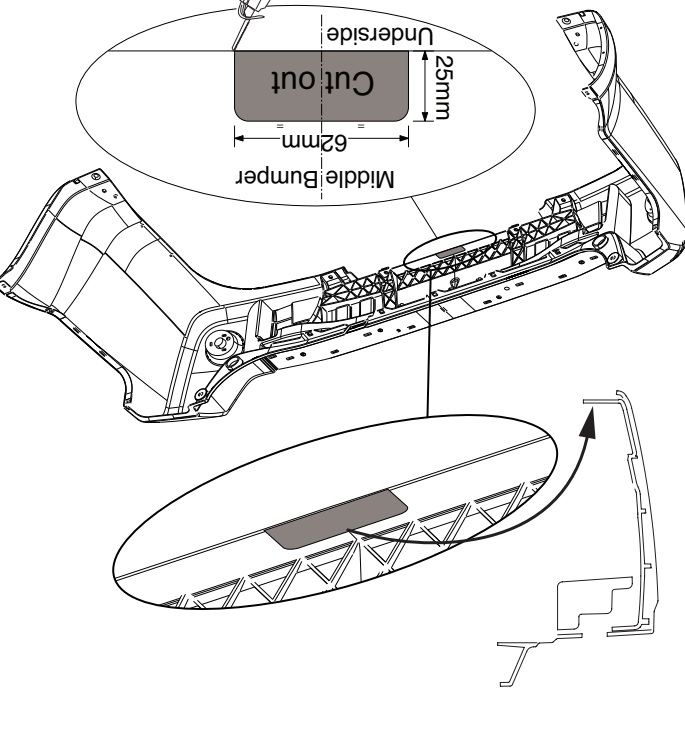

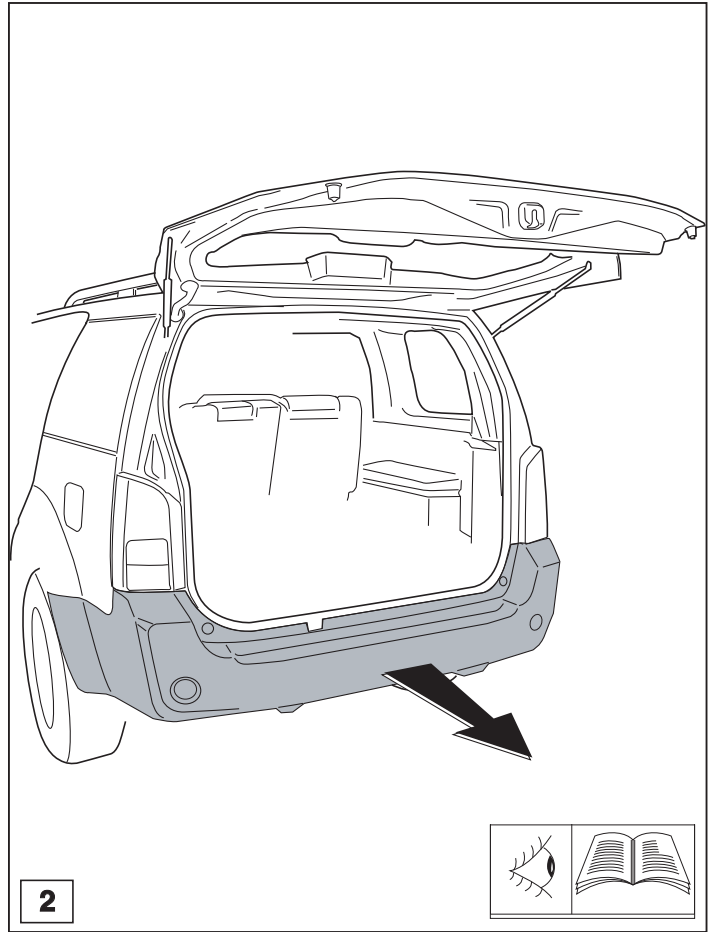
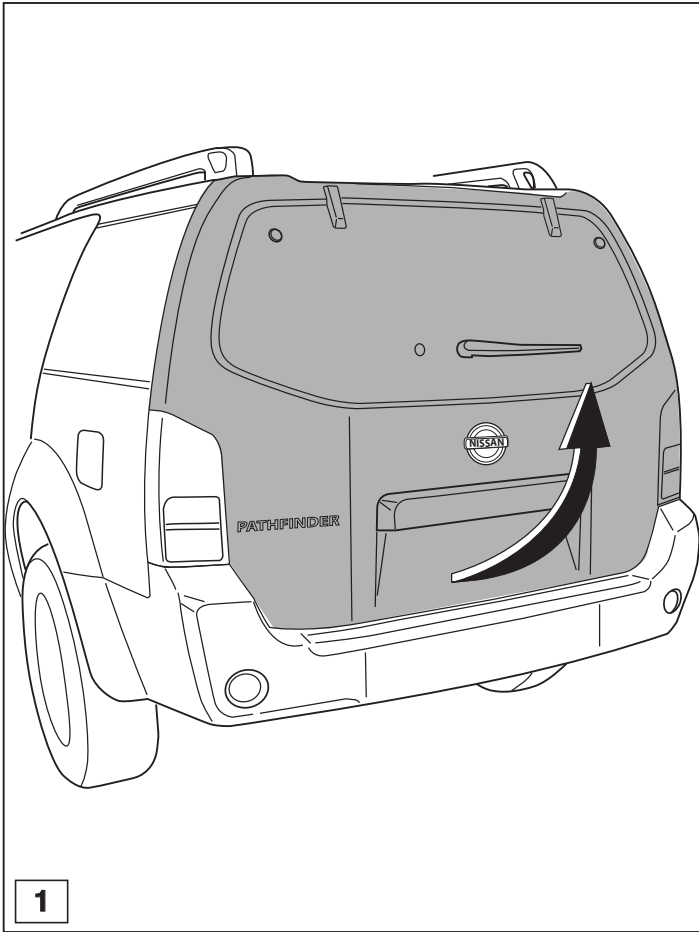

© 405470/05-09-08/5

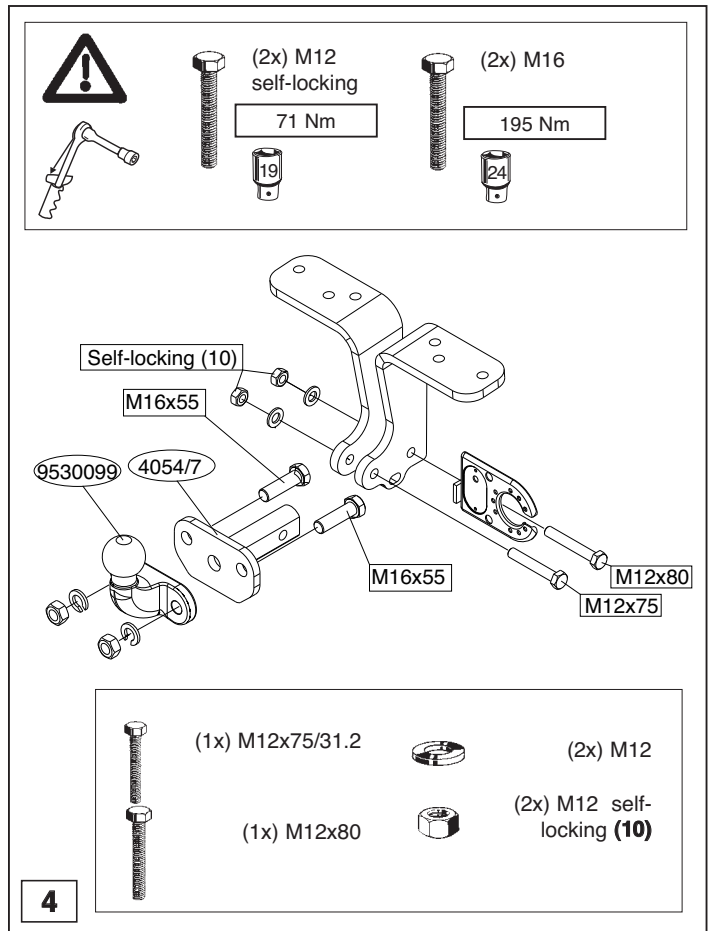
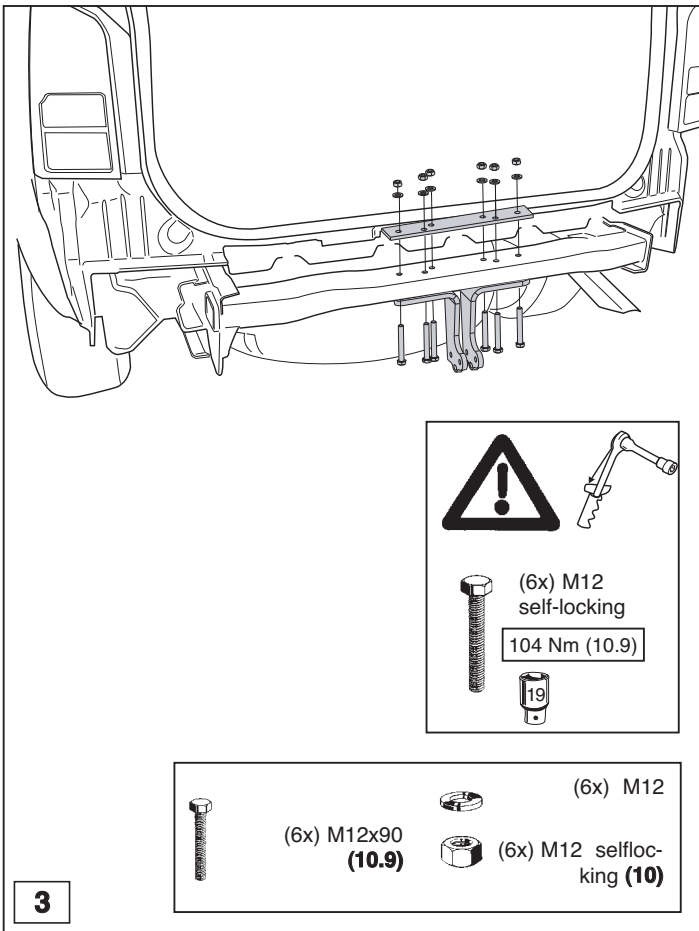

© 405470/05-09-08/6