

С

12 1,25 75	2 .
10 1,25 35	8 .
10 110	4 .
12 40	4 .
10 (/ .)	4 .
12 (/ .)	2 .
12 1,25 (/ .)	2 .
10 (.)	8 .
12 (.)	2 .
10 (.)	16 .
12	10 .
VH 0208	1 .
0168	1 .
	1 .

	1 .
	1 .
	1 .
	1 .
	1 .







Момент затяжки

M6	9,5 Nm
M8	23 Nm
M10	46 Nm
M12	79 Nm
M14	125 Nm
M16	195 Nm
M10x1,25	49 Nm
M12x1,25	87 Nm
M12x1,5	83 Nm

462800, « - »
18
.: (35363) 7-05-06
./ : (35363) 7-13-20
(495) 799-13-46
www.bosal-autoflex.ru
www.bosal.com
info@bosal-autoflex.ru



.....	:
.....	VIN
.....

	4163 Mitsubishi Lancer  2012/1 ⇒	 				D		Bosal Autoflex Russia BAR 28

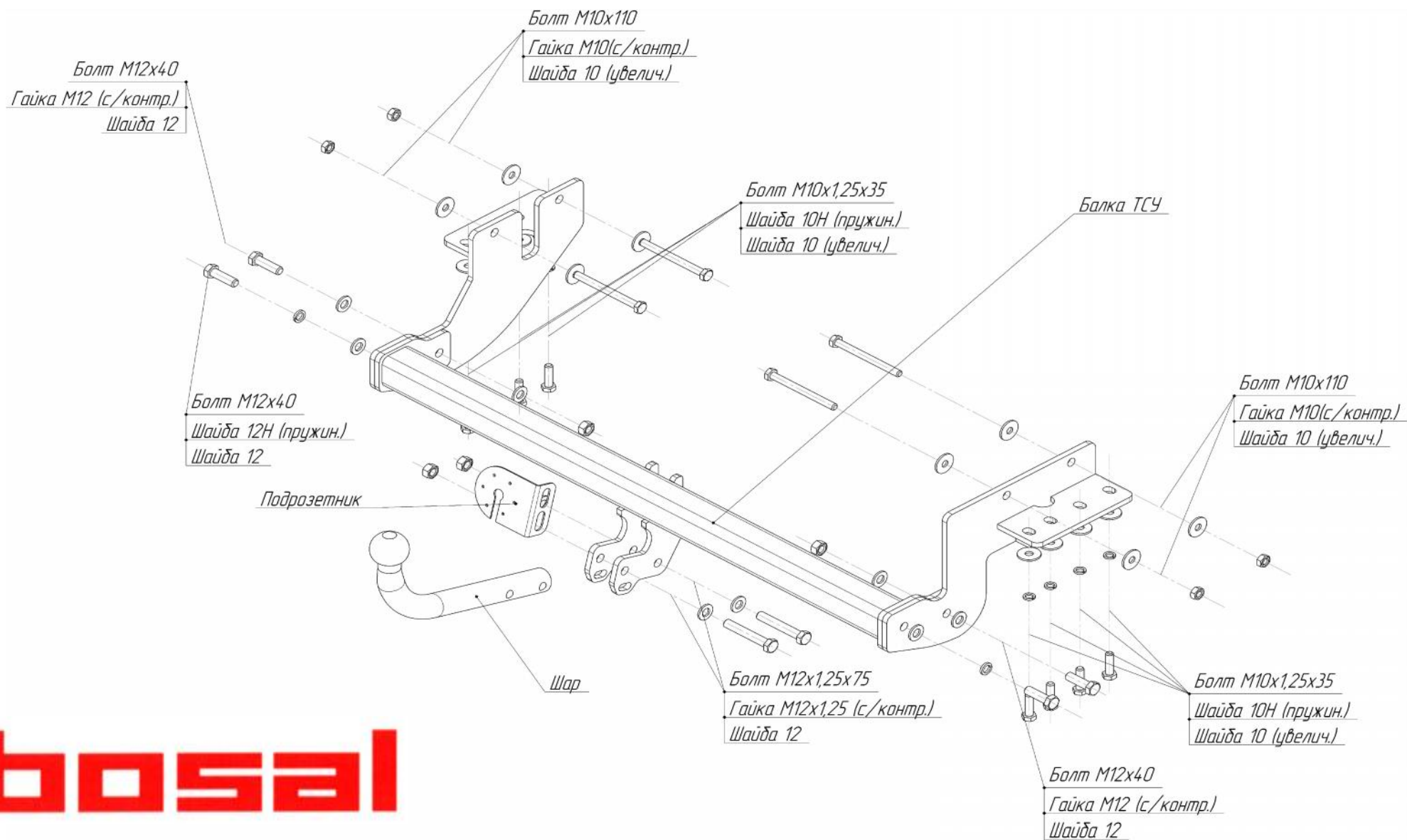

bosal